

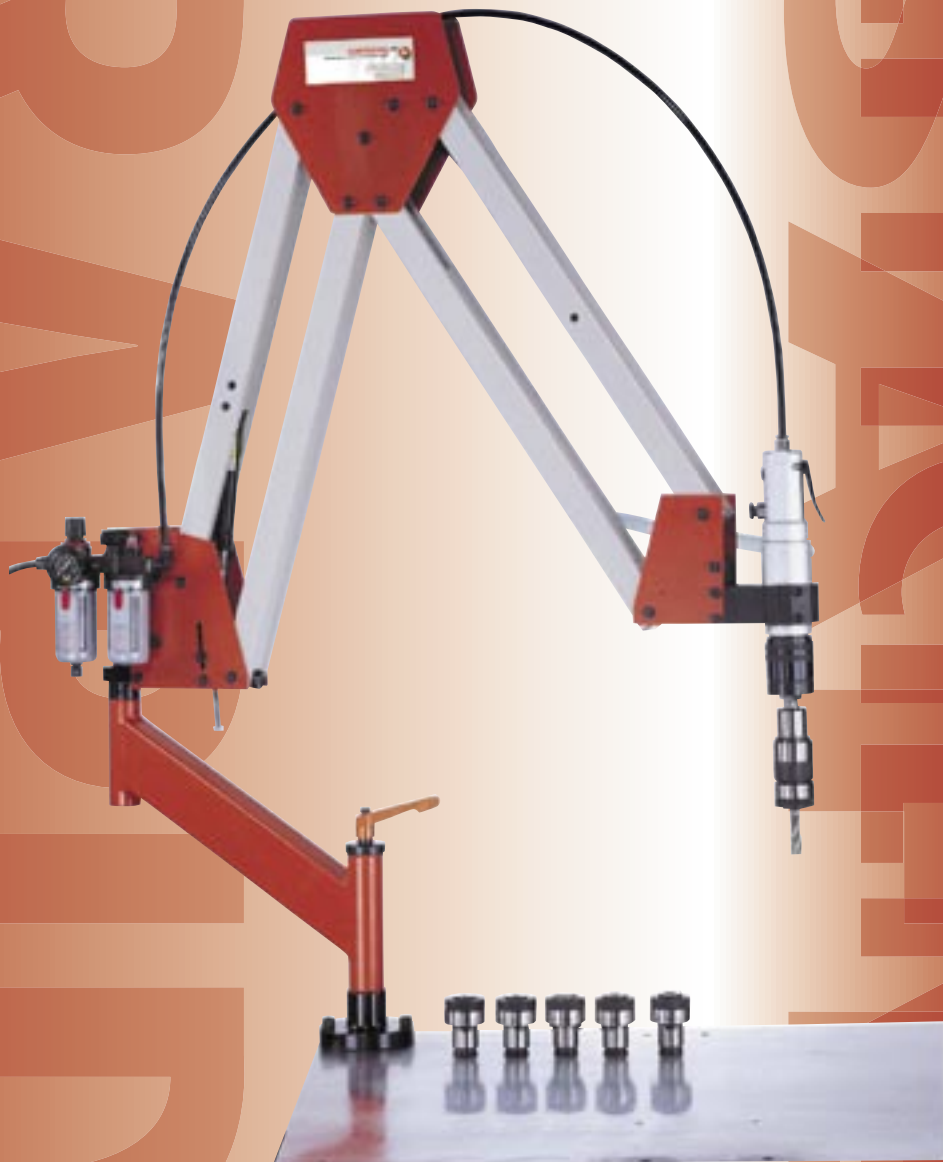

M O D E L S
AT-08/II AT-12/II AT-16/II AT-20/II AT-22/II AT-27/II

AIR TAPPING MACHINE

SAFE, EFFICIENT, RAPID



AIR TAPPING MACHINES

M O D E L

AT-08/II, AT-12/II



Model	AT-08/II	AT-12/II
Tapping Size	M2 - M8	M3 - M12
Speed (rpm)	700	400
Air Consumption/Pressure	750 l/min 6-7 bar	
Work Range	Rmin 300 mm - Rmax 1900 mm	
Parallel Arm Structure	from solid-aluminium-profile (38 x 29)	
Weight (kg)	23	23
Adapter Type	TCS 1B	TCS 1B
Item No.	50-10-08	50-10-12

- STANDARD EQUIPMENT:**
- Parallel arm
 - Air tapping spindle
 - 6 piece safety clutch tapping adapter TCS 1B of your choice
 - Table mounting column
 - Radial jib (for a more flexible workspace)
 - Air service unit
 - Pneumatic oil for initial fill

M O D E L

AT-16/II



Model	AT-16/II
Tapping Size	M3 - M16
Speed (rpm)	300
Air Consumption/Pressure	950 l/min 6-7 bar
Work Range	Rmin 300 mm - Rmax 1900 mm
Parallel Arm Structure	from solid-aluminium-profile (38 x 29)
Weight (kg)	27
Adapter Type	TCS 2B
Item No.	50-10-16

- STANDARD EQUIPMENT:**
- Parallel arm
 - Air tapping spindle
 - 6 piece safety clutch tapping adapter TCS 2B of your choice
 - Table mounting column
 - Radial jib (for a more flexible workspace)
 - Air service unit
 - Pneumatic oil for initial fill

AT-20/II, AT-22/II, AT-27/II



Model	AT-20/II	AT-22/II	AT-27/II
Tapping Size	M3 - M20	M3 - M22	M3 - M27
Speed (rpm)	150/400	120/300	70/220
Air Consumption/Pressure	950 l/min 6-7 bar		
Work Range	Rmin 300 mm - Rmax 1900 mm		
Parallel Arm Structure	from solid-aluminium-profile (58 x 40)		
Weight (kg)	39	39	39
Adapter Type	TCS 2B	TCS 2B	TCS 2B
Item No.	50-10-20	50-10-22	50-10-27

- STANDARD EQUIPMENT:**
- Parallel arm
 - Air tapping spindle
 - 6 piece safety clutch tapping adapter TCS 2B of your choice
 - Table mounting column
 - Radial jib (for a more flexible workspace)
 - Air service unit
 - Pneumatic oil for initial fill

TCS-B ADAPTER FOR SAFETY-CLUTCHES

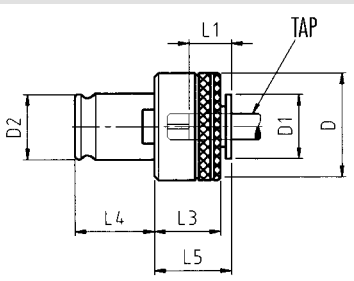

Model	for	Size	D	D ₁	D ₂	L ₁	L ₃	L ₄	L ₅	Weight
TCS 1B	M3-M14	1	32	19	19	71	25	21,5	25	0,15 kg
TCS 2B	M5-M27	2	50	30	31	30	30	35	33	0,55 kg

Dimension Ø x □	3,5x2,7	4x3	4,5x3,4	6x4,9	7x5,5	8x6,2	9x7	10x8	11x9	12x9	14x11	16x12	18x14,5	20x16
DIN 376	M3	M3,5	M4	M5 M6 M8	M10		M12		M14	M16	M18	M20	M22 M24	M27
DIN 371	M3	M3,5	M4	M5 M6		M8		M10						

TRE ADAPTER FOR REDUCING

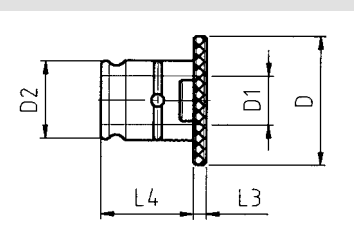

Model	from Size	to Size	D	D ₁	D ₂	L ₃	L ₄	Weight
TRE 2/1	TCS 2B	TCS 1B	48	19	31	5	35	0,17 kg

TAPPING MACHINE ACCESSORIES

PORTABLE MAGNETIC BASE with tapping intake for the TLM 300/600



Model	Holding force	Dimension (LxWxH)	Suited for	Weight	Item No.
TLM-300	300 kg	150/90/90	AT08/AT12	8,6 kg	50-23-01
TLM-600	600 kg	224/115/120	AT16/AT20/ AT22/AT27	21 kg	50-23-02

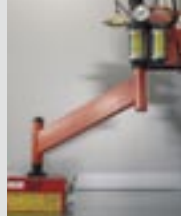

- ADVANTAGES:**
- Flexible place of work
 - Regardless of the location of the project pieces, the tapping arm is always vertical to the borehole
 - No need to adjust the tapping arm to the project piece.

MULTIPOSITION HEAD 90° and various degree tapping device



It is available in model series AQ/AT/HM/HMT.

LUBRICATION SYSTEM



This lubrication system is minimum quantity (MMS) for applying thin cutting fluids in intervals from a distance. The cutting fluid is flowing from a reservoir into the piston chamber of the MMS. The piston of the MMS is accelerated by a pulse of air pressure and shoots a drop of cutting fluid through the nozzle. In comparison to simple injector systems, this machine offers the major advantage that the lubricant **is not mixed with air** and does not create any unwanted oil mist in the immediate vicinity of the operator.

It is available in model series AT/HM/HMT/EMT.

- ADVANTAGES:**
- Increased durability
 - Defined set of lubricant quantity per pulse (manually adjustable)
 - Precise droplet formation without the addition of air
 - User-friendly (no oil mist)

